

# Landmark Arts Centre Contemporary Textiles Fair

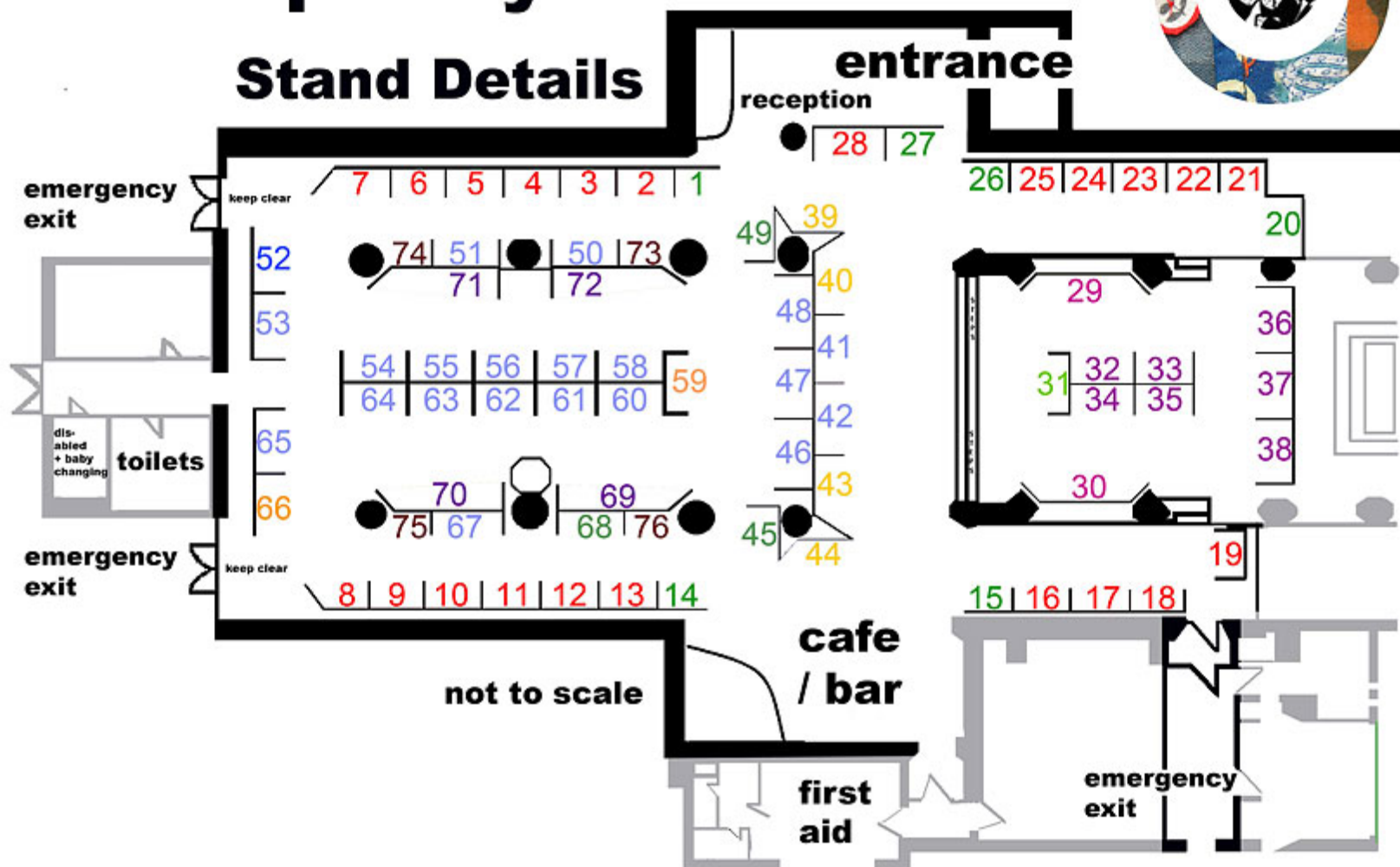

## Stand Details



### stands 2-13, 16-19, 21-25 and 28: £180

four panels in box shape (stands 7 and 8 - one end panel is angled)  
2m wide x 1m deep x 2m tall



### stands 52 and 66: £290

three panels - one open end  
2.4m wide x 1.2m deep (one end semi open) x 2.4m tall

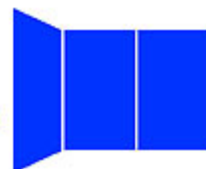

### stands 1,14,15,20,26 and 27: £180

three panels in box shape  
2m wide x 1m deep x 2m tall



### stands 41,42,46-48,50,51,53-58,60-65,67 and 68: £290

four panels in box shape  
2.4m wide x 1.2m deep x 2.4m tall

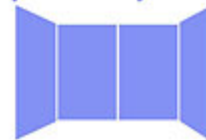

### stands 29 and 30: £370

three panels in a box shape  
2.9m wide x 1.2m deep (angled end panels) x 2.4m tall

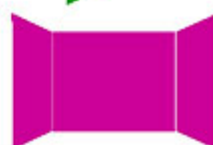

### stands 45 and 49: £290

three panels - open one end  
2.4m wide x 1.2m deep x 2.4m tall



### stand 31: £260

four panels in box shape  
back panels (total size) 2.4m wide x 1m deep  
x 2.4m tall back panels, 2m tall side panels



### stand 59: £260

four panels in a box shape  
2.4m wide x 1m deep x 2m tall



### stands 32 - 38: £290

four panels in a box shape  
2.4m wide x 1.2m deep x 2.4m tall



### stands 69 - 72: £420

five panels in a box shape  
3.6m wide x 1m deep (one end panel is angled) x 2m tall



### stands 39,40,43 and 44: £290

three panels - one open end  
2.4m wide x 1.2m deep (one end angled)



### stands 73 - 76: £140

two panels - one open end  
1.2m wide x 1.2m deep x 2.4m tall

