

# Paper / Ink / Print Festival Stand Plan

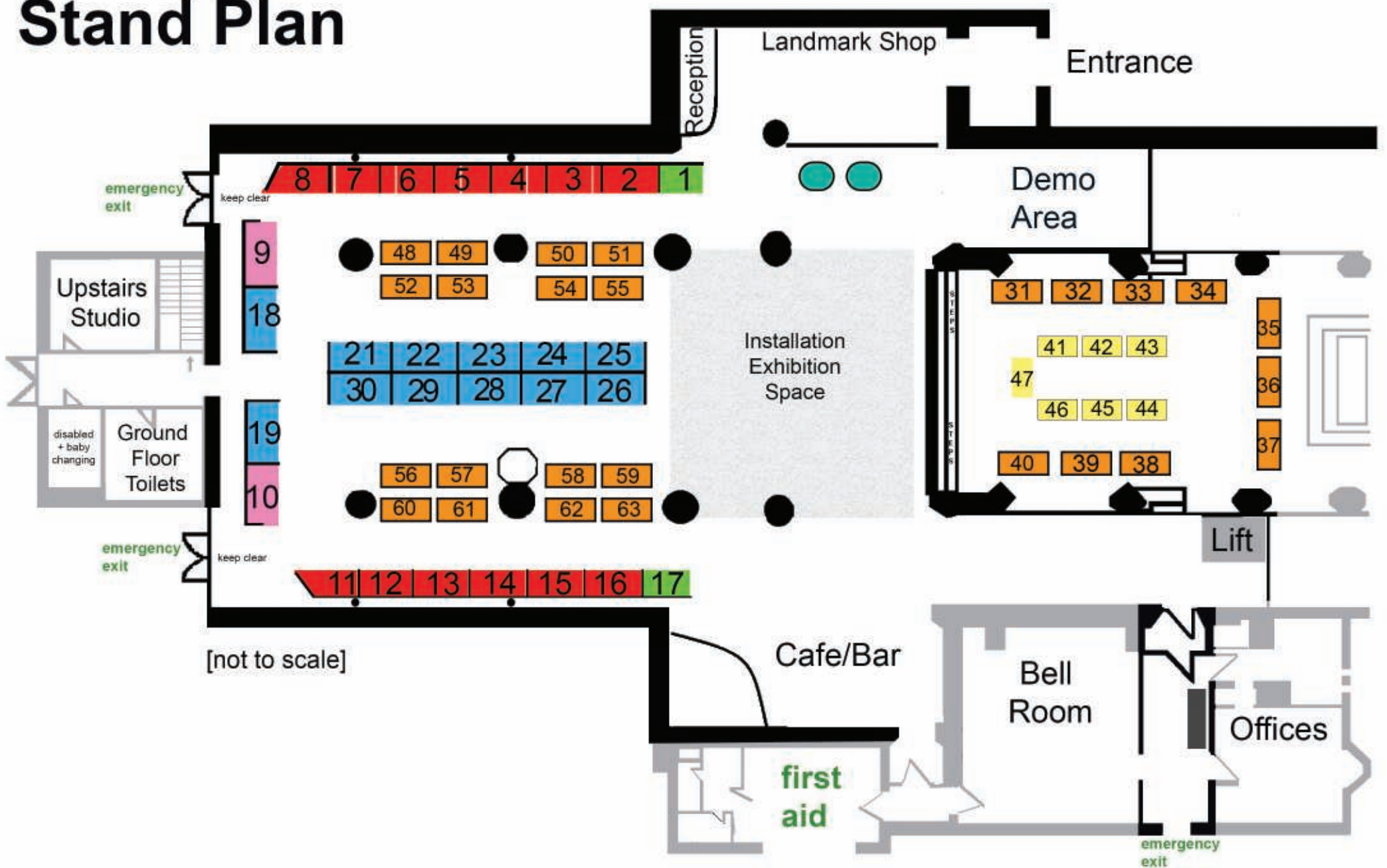

## Main Stands

## Tables

### Stands 2-8, 11-16:

**£150+VAT (£180 total)**

four panels in box shape (stands 8, 11 - one end panel is angled)  
2m wide x 1m deep x 2m high

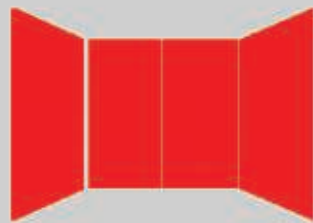

### Stands 1 & 17:

**£150+VAT (£180 total)**

three panels in box shape  
2m wide x 1m deep x 2m high



### Stands 9 & 10:

**£190+VAT (£228 total)**

three panels - open box shape  
2.4m wide x 1.2m deep (one end semi open) x 2.4m high

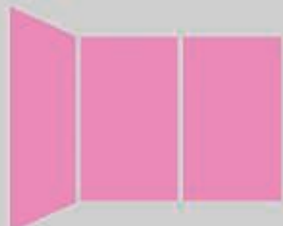

### Stands 18 & 19, 21-26:

**£190+VAT (£228 total)**

four panels in box shape  
2.4m wide x 1.2m deep x 2.4m high

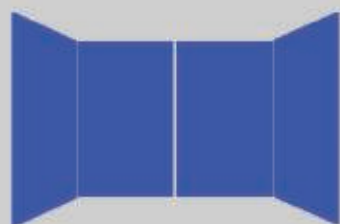

### Large Tables (Stage)

**31-40:**

**£50.00+VAT (£60 total)**

31-34 & 38-40: 75cm wide x 150cm long tables  
35-37: 76cm wide x 182cm long trestles



### Small Tables

**41-47:**

**£38.00+VAT (£45.60 total)**

61cm wide x 114cm long tables



### Large Tables (Hall)

**48-63:**

**£65.00+VAT (£78 total)**

76cm wide x 182cm long trestles



### Display Cabinets From £40+VAT



please enquire if interested