

Sparkle Festive Fair Stand Plan

LANDMARK
ARTS CENTRE

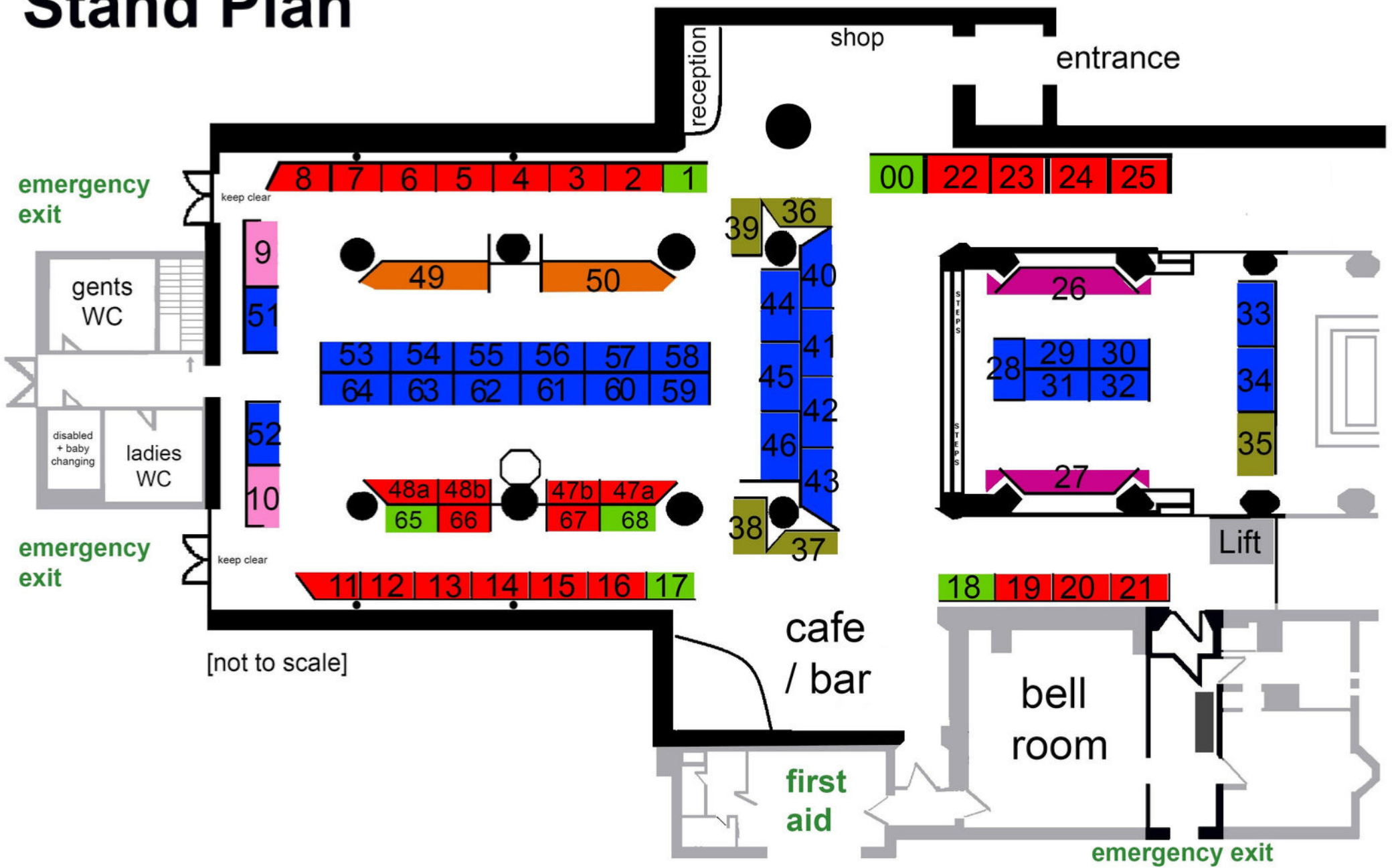

Large Stands

Stands 28-34, 40-46, 51-64 :
£242 +VAT

four panels in box shape (stands 40 & 43 are angled at one end)
2.4m wide x 1.2m deep x 2.4m high

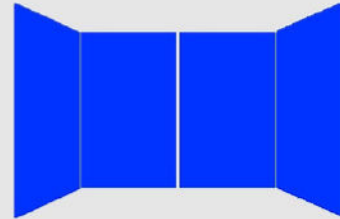

Stand 35-39:
£242 +VAT

three panels - open box shape
2.4m wide x 1.2m deep x 2.4m high (one end angled)

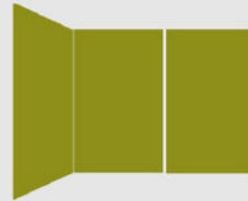

Stands 9 & 10 :
£242 +VAT

three panels - open box shape
2.4m wide x 1.2m deep (one end semi open) x 2.4m high

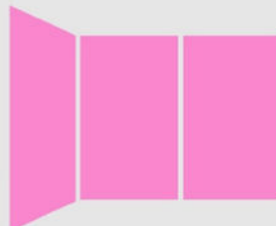

Stand 26 & 27:
£258.50 +VAT

five panels
2.9m wide x 1.2m deep (angled end panels) x 2.4m high

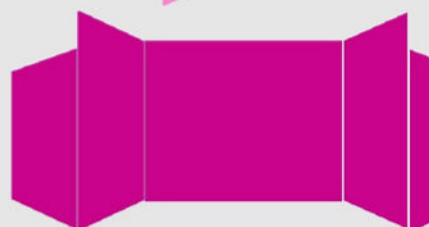

Stands 49 & 50 :
£302.50 +VAT

five panels in a box shape;
three x 2.4m high x 1.2m wide back panels,
two x 2m high x 1m wide side panels



Small Stands

Stands 1, 17, 18, 00, 65 & 68 :
£209 +VAT

three panels in box shape
2m wide x 1m deep x 2m high
Please note; stands 65 & 68 are 'interrupted' by a column on one side. Please ask Abigail for an image.

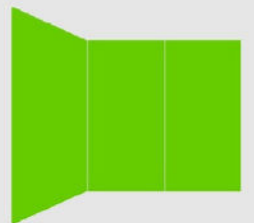

Stands 2-8, 11-16, 19-21, 32-25, 48a, 48b, 47a, 47b, 66 & 67:
£209 +VAT

four panels in box shape (stands 8 and 11 - one end panel is angled)
2m wide x 1m deep x 2m high

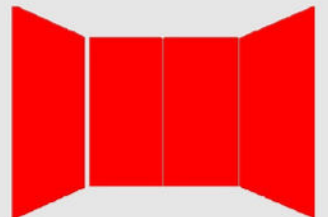

Food & drink vendors are welcome to apply for any stand; please get in touch with any questions: abigail@landmarkartscentre.org