

# Art Fairs 2024 Stand Plan

LANDMARK  
ARTS CENTRE

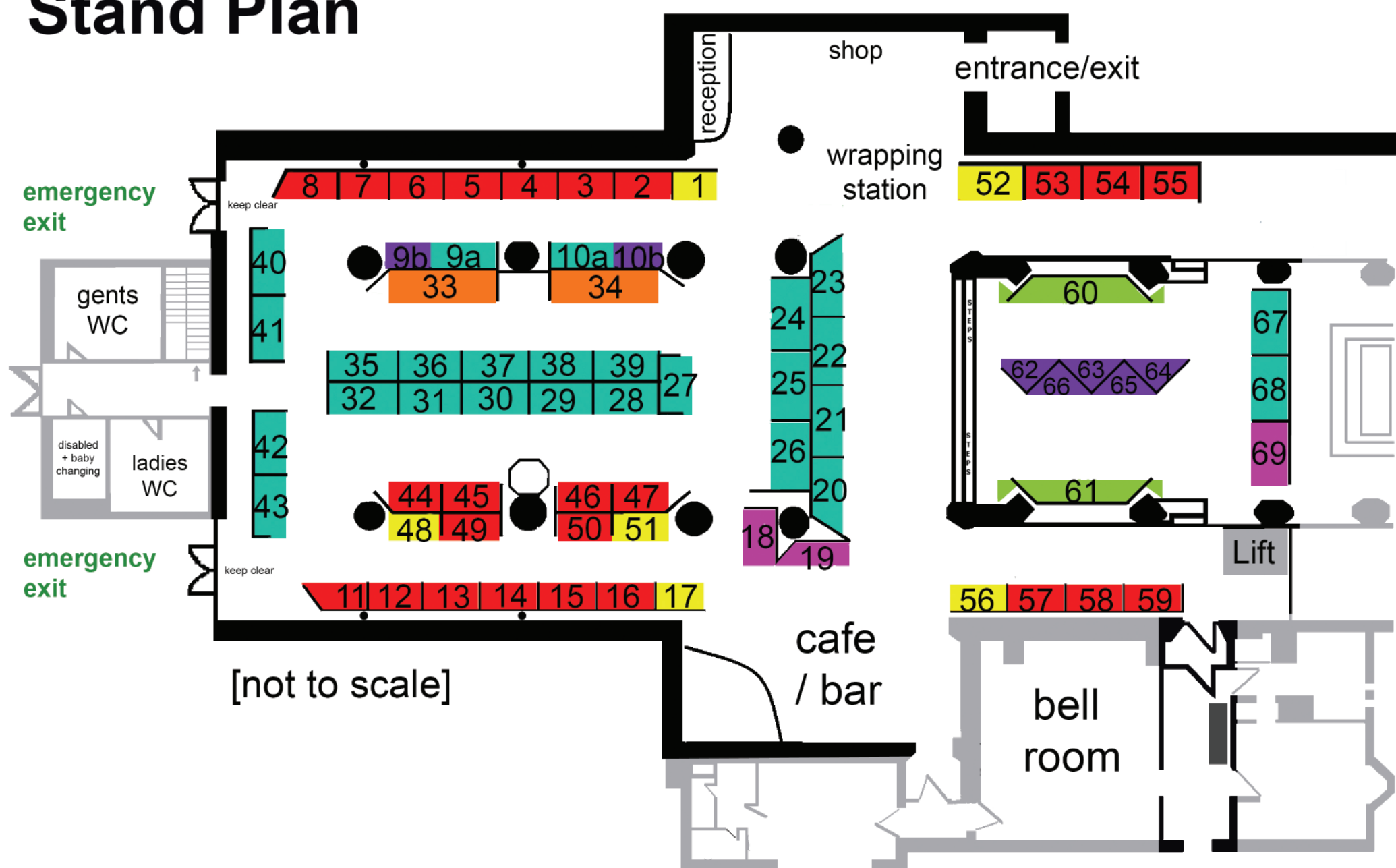

## Large Stands

**Stands 9a & 10a, & 20-32,  
35-43, 67-68:**  
**£434.50+VAT**

four large panels in box shape (stands 20 & 23 are angled at one end - large panels are 2.4m high x 1.2m wide each)  
Whole Stand is: 2.4m wide x 1.2m deep x 2.4m high  
(inc. one LED light at the centre back)

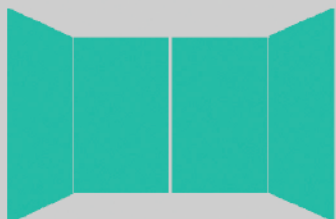

**Stand 18, 19 & 69:**  
**£434.50+VAT**

three large panels - open box shape  
Whole Stand is 2.4m wide x 1.2m deep x 2.4m high  
(stand 19 has one end angled - large panels are 2.4m high x 1.2m wide each)  
(inc. one LED light at the centre back)



**Stands 60 & 61:**  
**£484+VAT**

five panels  
back panel is 2.9m wide x 2.4m high  
side panels are 1.2m wide x 2.4m high  
(angled end panels are only 70cm high)  
(inc. two LED lights)

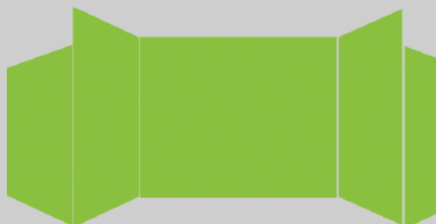

**Stands 33 & 34:**  
**£618.20+VAT**

five panels in a box shape;  
three x 2.4m high x 1.2m wide back panels,  
two x 2m high x 1m wide side panels  
(inc. two LED lights)

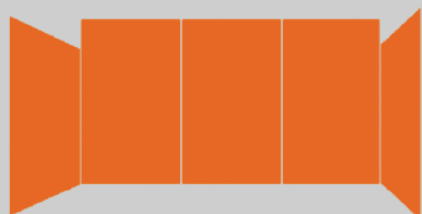

## Small Stands

**Stands 2-8, 11-16, 44-47, 49-50,  
53-55 & 57-59:**  
**£242+VAT**

four small panels in box shape (stands 8, 11, 44 & 47 - one end panel is angled)  
Whole Stand is 2m wide x 1m deep x 2m high  
(small panels are 1m wide x 2m high each)  
(inc. one LED light at the centre back)

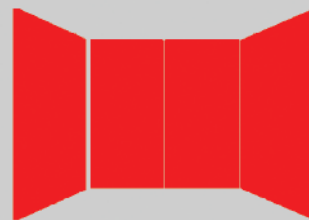

**Stands 1, 17, 48, 51, 52 & 56:**  
**£242+VAT**

three small panels in box shape  
2m wide x 1m deep x 2m high (small panels are 1m wide x 2m high each)  
(inc. one LED light at the centre back)

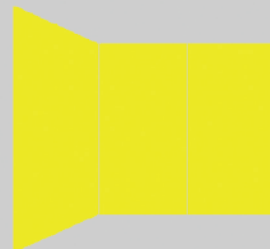

**Stands 9b & 10b (L-shape)  
& 62-66 (V-shape):**  
**£209+VAT**

two large panels in an open V-shape or L-shape  
each panel is 1.2m wide x 2.4m high  
(inc. one LED light)



**Extras:**

**Table 6ft x 2ft 6" (183 cm x 76 cm) 29.5" (75cm) high: £8+VAT**  
**Electric Socket: £8+VAT.**